



# PGP® NetShare

Policy-enforced file encryption for collaborating teams

Part of the PGP® Encryption Platform



## Benefits

- **Easy, automatic operation** – Protects shared files without changing the user experience.
- **Enforced security policies** – Automatically enforce data protection based on application or data location with centrally managed policies.
- **Accelerated deployment** – Achieves network file encryption using the existing infrastructure.
- **Reduced operation costs** – Result from centrally automating data encryption policies.

## PGP Customer Spotlight

Bertelsmann, an international media company active in more than 60 countries, uses PGP® NetShare to encrypt files shared via centrally hosted servers, protecting this highly confidential data from being viewed by administrators.

## Secure files on desktops and shared between colleagues within and beyond the enterprise

File servers have emerged as an industry-standard tool for enabling users to collaborate and share large files. Unfortunately, unprotected files pose a critical risk to an enterprise's most sensitive data: customer information, financial data, trade secrets, and other proprietary information. Exposure of this data can result in financial loss, legal ramifications, and brand damage.

PGP NetShare protects data on desktops and enables teams to securely share documents on file servers by automatically and transparently encrypting the files for fine-grained group access. This approach ensures that only authorized users can read or modify files, fulfilling partner and regulatory requirements for information partitioning and security.

PGP NetShare extends file server access controls to include strong end-to-end encryption, allowing content owners or security administrators to specify access rights for specific groups or individuals. Administrators can centrally define policies to protect data by application or location. With PGP NetShare, organizations can defend their intellectual property, customer and partner data, and corporate brand equity.

### Persistent File Encryption on Desktops and Network Servers

With PGP NetShare, authorized users can save and share encrypted files, with no change required to applications or user behavior. Content such as documents, spreadsheets, presentations, video, and audio is automatically encrypted when saved by a NetShare-protected application or to a PGP NetShare-protected folder. The content remains encrypted when created on or transferred to desktops.

### PGP Encryption Platform-Enabled

PGP NetShare is a PGP Encryption Platform-enabled application. The PGP Encryption Platform provides a strategic enterprise encryption framework for shared user management, policy, and provisioning, automated across multiple, integrated encryption applications. As a PGP Encryption Platform-enabled application, PGP NetShare can be used with PGP Universal™ Server to manage existing policies, users, keys, and configurations, expediting deployment and policy enforcement. PGP NetShare can also be used in combination with other PGP encryption applications to provide multiple layers of security.

## Easy, Automatic Operation

Once PGP NetShare is deployed, its operation is completely transparent—users simply continue to work as usual. The software automatically encrypts and decrypts documents on-the-fly, ensuring that users never forget to secure data.

- **Remote application delivery support** – Protect data in Citrix and Microsoft Terminal Server sessions.
- **Encryption that follows the file** – Ensures files stay encrypted locally, over the network, on the server, and in backups.
- **Role separation** – Enforces different permission levels for content users, owners, and administrators, restricting each to the minimum required to perform tasks.

## Enforced Security Policies

Security policy configured in PGP Universal Server ensures that documents are secured automatically, without changes in user behavior.

- **Protect data by application policy** – Enforce encryption for desktop applications, securing documents wherever stored or used.
- **Client controls** – Enable the organization to better meet security requirements by locking down which features are enabled, visible to the user, and enforced.
- **Centrally defined folder protection** – Defines policy to protect files stored in specific directories, enforcing security without impacting user behavior.
- **Data protection logging** – Tracks the protection applied by PGP NetShare within the organization, to assist in satisfying management and auditor requirements.

## Accelerated Deployment

Used together, PGP NetShare and PGP Universal Server establish, enforce, and update file encryption policy in real time. This combination reduces the time and effort required to deploy encryption.

- **Automated enrollment** – Leverages existing infrastructure to deploy encryption without infrastructure changes.
- **Rapid deployment process** – Speeds deployment by automating the installation and configuration process.

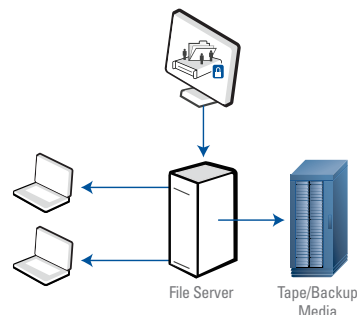

Secures documents on desktops, exchanged over the network, or on backup media.

## Reduced Operation Costs

With PGP NetShare, no special training is required for end users. This approach accelerates deployment time, reduces training costs, and avoids any increase in help desk calls.

- **Flexible, scalable security** – Allows PGP NetShare to scale to include thousands of users without degrading system, server, or network performance.
- **Administration role delegation** – Centrally controls which users can change permissions on protected folders.

## PGP Universal Server Management

PGP NetShare can be centrally deployed and managed when used with PGP Universal Server (optional), enabling organizations to easily set and enforce data security policies throughout the enterprise.

- **Centrally enforced security policy** – Automatically enforces protection of sensitive data using security policies driven by an existing corporate directory.
- **Extensible protection** – Allows management of PGP® Desktop Email or any other PGP Encryption Platform-enabled application.

## Technical Specifications

PGP NetShare supports Windows Vista (all 32- and 64-bit editions), Windows XP (SP1, SP2, and SP3), and Windows 2000 Professional (SP4). For complete technical specifications and operating system supported functionality, please visit [www.pgp.com](http://www.pgp.com).

PGP and the PGP logo are registered trademarks of PGP Corporation. Product and brand names used in the document may be trademarks or registered trademarks of their respective owners. Any such trademarks or registered trademarks are the sole property of their respective owners.



PGP Corporation  
[www.pgp.com](http://www.pgp.com)

PGP Corporate Headquarters  
Tel: +1 650 319 9000

PGP (GB) Ltd.  
Tel: +44 (0)20 8606 6000

PGP Deutschland AG  
Tel: +49 69 838310 0

PGP Japan K.K.  
Tel: +81 03 4360 8308

© 2009 PGP Corporation  
NSDS090323